

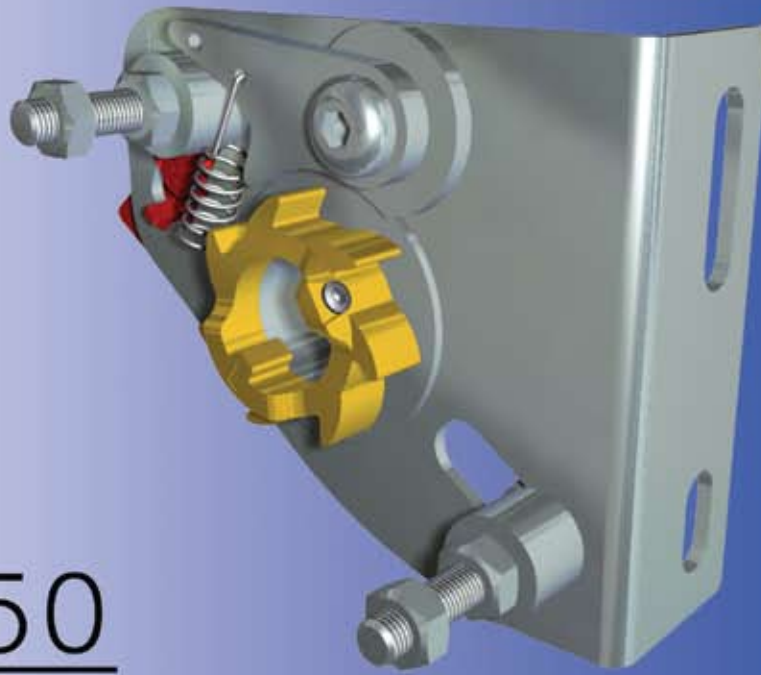

Spring break device

25651



25650

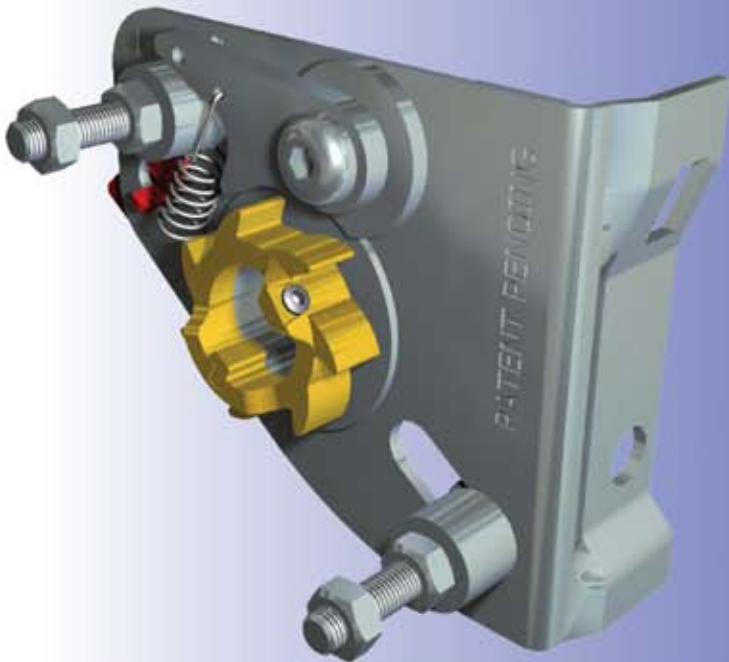

Installation manual



## 1. Symbols and warning notices

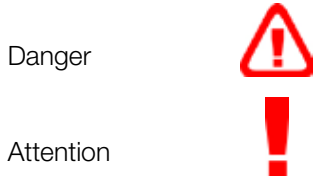

## 2. General warning notices

This installation manual is intended for suitably qualified staff and not for trainees or do-it-yourselfers. If anything relating to installation and/or maintenance is unclear, please contact DOCO International who will help to resolve your problem.

In order to avoid serious injury, all information and instructions provided must be read thoroughly and the provisions strictly adhered to.

- This manual describes installation and removal of spring break devices 25650 and 25651.
- This anti-drop device has been designed in line with current European standards Please check for yourself whether this standard is in compliance with your national standard.
- The addition or removal of any parts may affect the function and thus the safety of the sectional door and it is strongly advised that such changes are not made!
- All information concerning right-hand/left-hand installation refer to the place of installation, i.e., looking from the inside to the outside.
- All dimensions are quoted in millimetres unless specified otherwise.
- Always replace any anti-drop devices which have been activated.
- The required fasteners for installing the anti-drop device on a wall or a console, e.g., dowels, bolts, nuts, etc, do not form part of the scope of supply!
- Subject to technical modification without written notice.
- Store this manual securely in a safe place.
- This manual shows spring break device 25650 as an example.

## 3. Scope of application

This spring break device is designed for domestic garage doors which are provided with a spring assembly. The safety wheel is provided with a positive wedge so that installation is only possible on an axis which has an appropriate keyway. This anti-drop device can be used for manually operated, chain or motor driven doors of domestic garages.

Certificate number: P902383 (SP).

Suitable for 60 Nm / Spring.

To calculate the maximum door weight per spring break device. Using for example a drum with a diameter of  $\varnothing 105$  mm:

$M$  (Nm) =  $F$  (n) x  $L$  (m),  $L = 0.5 \times \varnothing 105$ .

$60 = F \times 0.0525$ ,  $F = 1043$  N. ~ **116.5 Kg**

We recommend always to use two torsion springs to balance a door.

Springs

- 12003 -  $\varnothing 50$ mm,
- 12002 -  $\varnothing 67$ mm

### 3.1 Shafts

These spring break devices are suitable for following shafts:

- 25016
- 25018
- 25019
- 25516
- 26018



#### 4. Principle

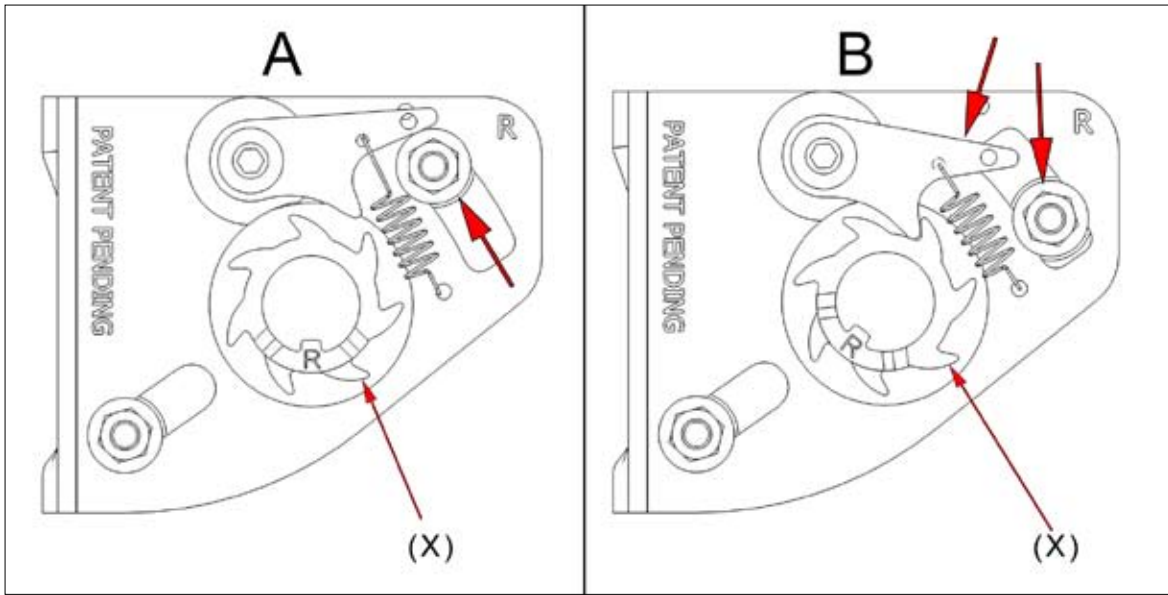

When the torsion spring is under tension, the protective device is in position A. If the spring breaks, the protective device falls into position B. The safety wheel (X) ensures that the door is prevented from falling down.

Required installation tools:

- Ring spanner/socket wrench, 13 mm
- Hexagon Socket Screw Key, 2 & 3 mm

#### 5. Installation

The fasteners required for installing this spring break device on a wall or a steel structure do not form part of the spring break device! It is the fitter's responsibility to ensure that the place of installation is sufficiently stable from a building technology perspective for the installation of the anti-drop device. Furthermore, the fitter is responsible for the use of appropriate fasteners to suit the installation surface.

Spring plug installation:

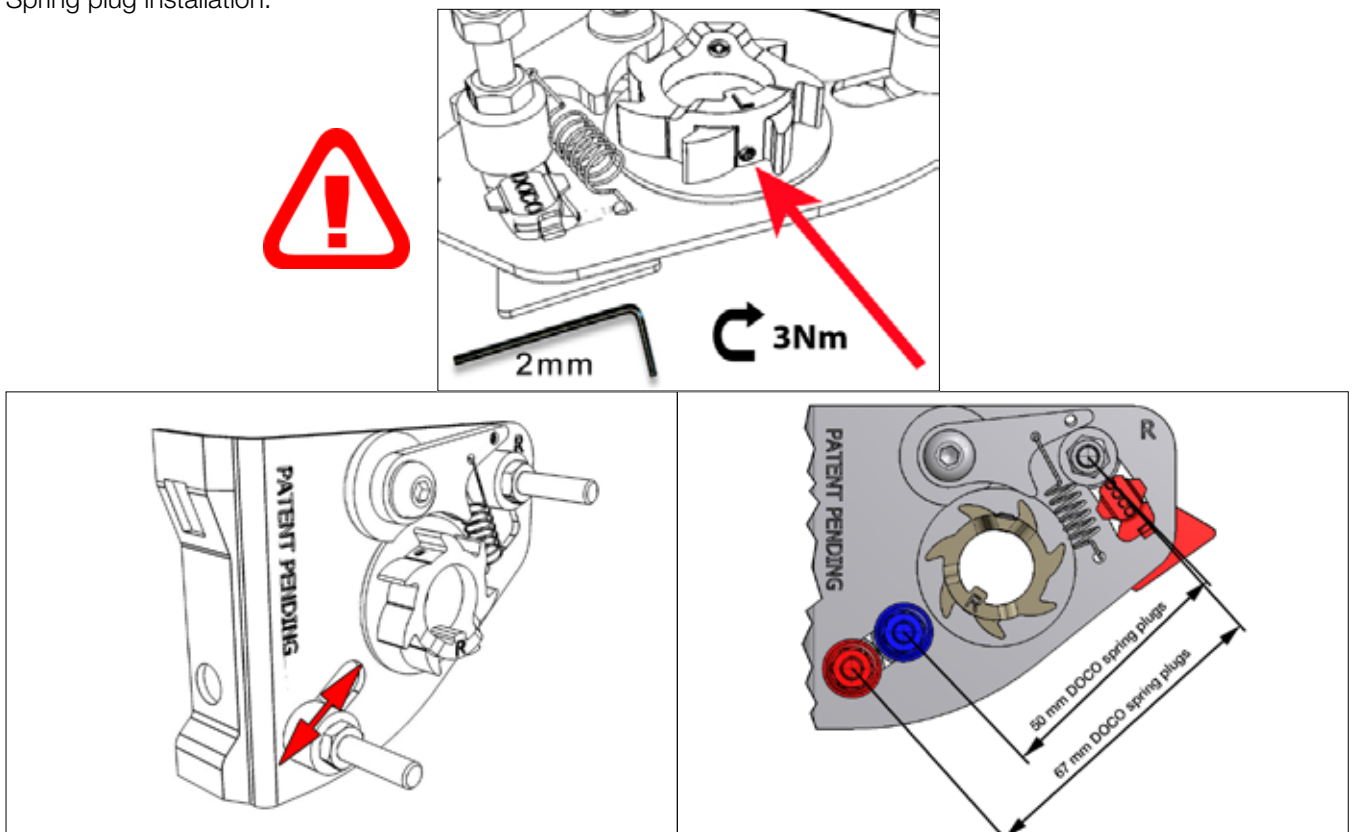

Spring break device for spring plugs of 50 mm and 67 mm.

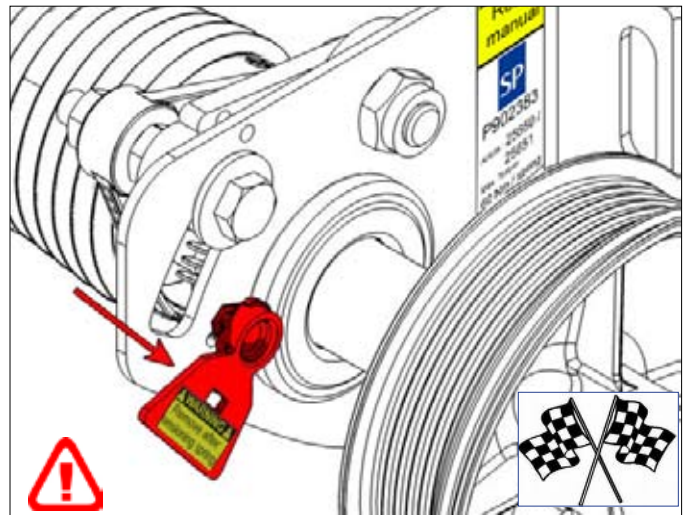
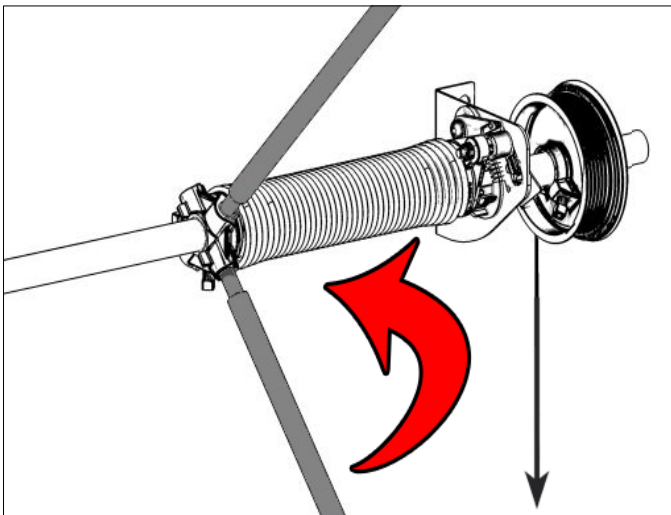
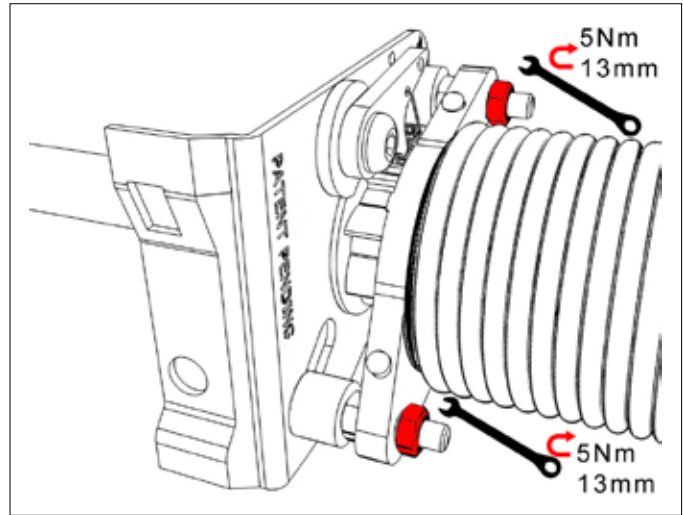
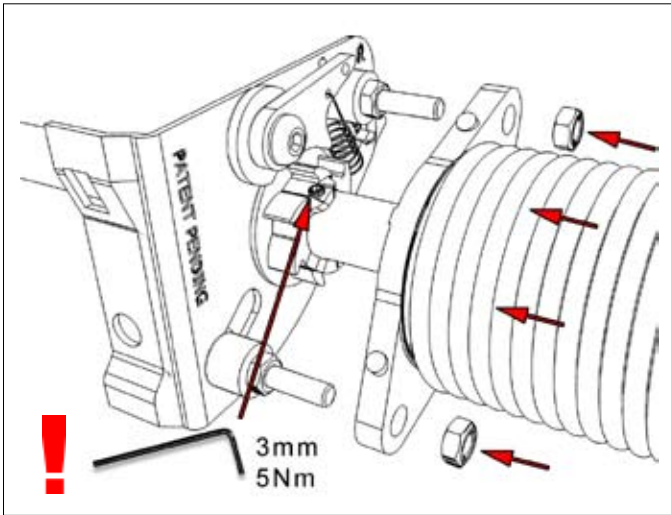

Installation 25650- L/R

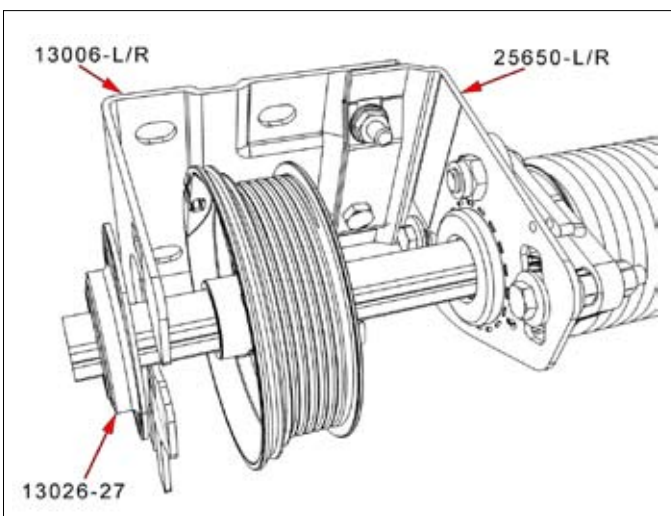

Components for front spring.

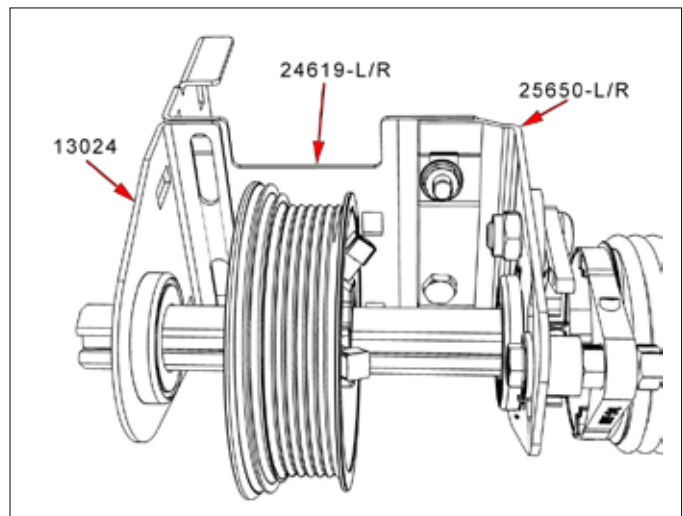

Components for rear spring.

## 6. Testing

During semi-annual maintenance/checking procedures, the door maintenance engineer must check the pressure of the auxiliary spring. For this purpose the red protection device is moved upwards; if the protector is pulled down by the spring, the spring power is sufficient. Replace the complete spring break device if it is broken.

## Maintenance

Basically the spring break device needs no maintenance. However it is recommended that dirt is avoided or removed on a regular basis.

## 7. Replacement

The spring break device may only be replaced by properly qualified staff. When replacing the device, the garage door is not in the rest position; always make sure that the leaf of the door is supported so that it cannot crash down.

- Step 1: Secure the leaf of the garage door using supports.
- Step 2: Push the door leaf further upwards so that the locking device can be removed from the safety wheel; secure the door leaf again.
- Step 3: Remove the locking device. For this purpose, remove the nuts and the broken spring.
- Step 4: Close the door.
- Step 5: Remove the defective spring and the anti-drop device; proceed according to the installation instructions.

It is recommended that all springs and spring break devices are replaced.

## 8. Contact

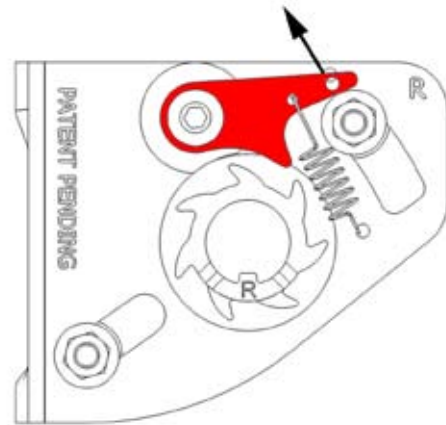

Doco International B.V.  
Nusterweg 96  
6136 KV Sittard  
P.O. Box 427  
6130 AK Sittard  
The Netherlands  
Tel: +31 (0) 464200666  
Fax: +31 (0) 464526894

Doco International Limited  
Unit 1 Northolt Trading  
Estate  
Belvue Road  
Northolt Middlesex  
UB5 5QS  
United Kingdom  
Tel: +44 (0) 20 8839 8587  
Fax: +44 (0) 20 8842 3661

Doco International  
Southern Europe S.L.U  
Components s.l.u  
P.I. Can Met Sidro  
Avenida Generalitat, 55  
08530 La Garriga /  
Barcelona  
España / Spain  
Tel: +34 9 3 861 28 25  
Fax: +34 9 3 871 65 92

Doco International s.r.o.  
Prostějov - Kralice na Hané  
Háj 352  
798 12 Kralice na Hané  
Czech Republic  
Tel: +420 582 360 100  
Fax: +420 582 360 300